

Modalità sparo - Fire mode selection

Colpo martello Bump fire

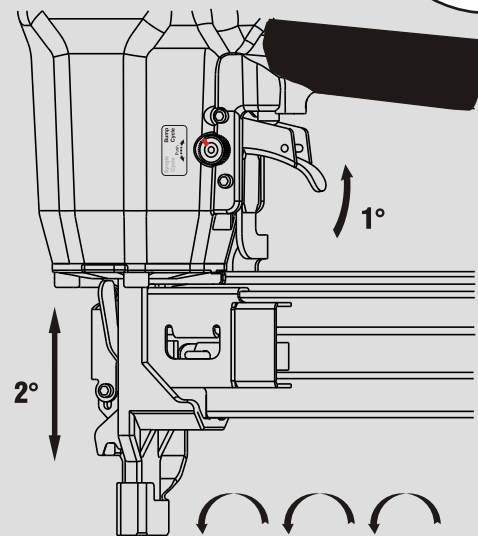

Colpo singolo Sequential fire

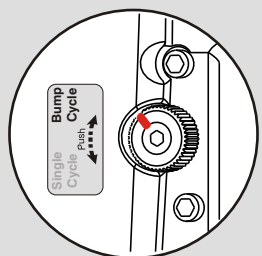
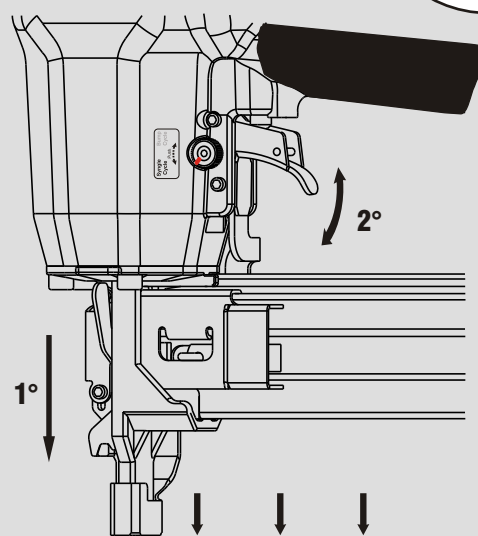
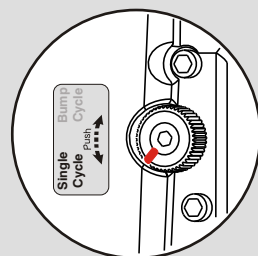

Caratteristiche - Features

Disinceppamento rapido macchina Quick clearance jammed nails

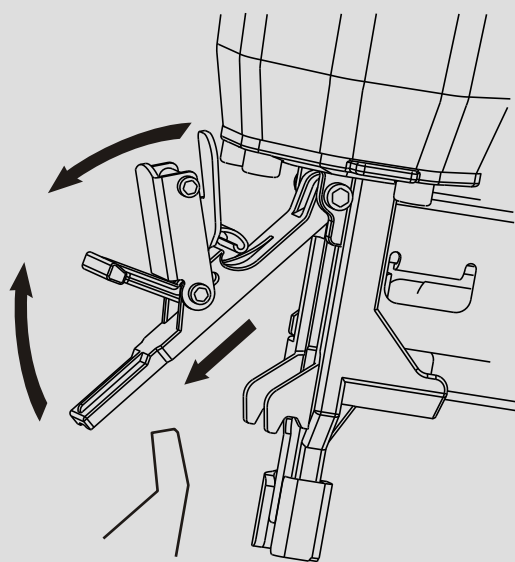

Acessori - Optional

Regolatore di profondità Depth adjustment

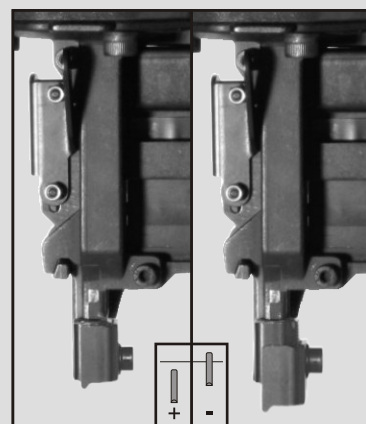

Cod. 75.82.2

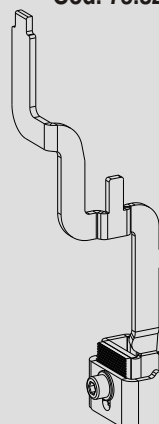

OMER

Manuale d'uso, manutenzione e parti di ricambio
Use, maintenance and spare parts manual
Gebrauchsanweisung, Instandhaltungsrichtlinien und Ersatzteile
Manuel d'utilisation, entretien et pièces de rechange
Manual de uso, mantenimiento y repuestos

Parte 2
Part 2
Teil 2
Partie 2
Part 2

Manual de utilização, manutenção e partes sobresselentes
Handleiding voor gebruik, onderhoud en reservedelslste
Brugsanvisning, vedligeholdelse og reservedelslste

Parte 2
Deel 2
Del 2



700.65 SB

cod. 1838310SB

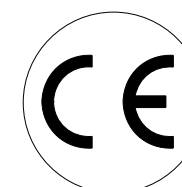

1838310SB_70065SB_3 130910 IV

| Dati tecnici Technical data Technische daten | Données techniques Datos tècnicos | Dados tècnicos Technischegegevens Tecniske data |
|--|--------------------------------------|---|
|--|--------------------------------------|---|

| | | | |
|--|---|--|-------------------------------------|
| Misure impiegabili mm Usable lengths mm Gebrauchliche Längen mm | Mesures utilisable mm Medidas que se pueden emplear mm | Medidas que se podem utilizar mm Te gebruiken engtes in mm Brugbare laengder i mm | 20 ÷ 65 |
| Capacità caricatore n° punti Magazine capacity No. of fasteners Magazinkapazität Nägel | Capacité chargeur n° de points Capacidad cargador n° puntos | Capacitade carregador n° pontos Capaciteit magazijn in aantal spijkers Kapacitet af magasin antal klemme | 145 |
| Pressione d'esercizio Working pressure Betriebsdruck | Pression de fonctionnement Presión de trabajo | Pressao de trabalho Werkdruk Arbejds tryk bar | 5 ÷ 7,5 bar 70 ÷ 105 psi |
| Consumo aria litri/colpo Air consumption litres/shot Luftverbrauch Liter/Schlag | Consommation air litre/coup Consumo aire-litros/golpe | Consumo ar litro/golpe Luchtverbruik liter/schot Luftforbrug liter/skud | 1,40 |
| Peso kg Weight kg Gewicht kg | Poids kg Peso kg | Peso kg Gewicht in kg Vaegt kg | 2,10 |
| Dimensioni (AxBxH) mm Dimensions mm Größe mm | Dimension mm Dimensiones mm | Dimencoes mm Afmetingen in mm Dimensioner mm | 355x98x282 |
| EN 12549 :1999 ISO 11201 :1995 | | | $L_{pA,1s}$ (Rif. 20µPa) |
| Pressione sonora in pos. operatore Sound pressure at the workstation Lärmintensität am Arbeitsplatz | Pression acoustique près de l'opérateur Presión sonora en posición encargado | Intensidade sonora perto do operador Geluidssterkte op de werkplek Lydstyrke på operatorposten | 86,7 dB(A) |
| EN 12549 :1999 ISO 3744 :1994 | | | $L_{WA,1s}$ (rif. 1pW) |
| Potenza sonora emessa Emitted sound power Ausgestrahlte Lärmintensität | Puissance acoustique émise Potencia sonora emitida | Potência sonora emitida Uitgestraalde geluidssterkte Udsendt lydstryrke | 97,9 dB(A) |
| EN 28662 :1992 ISO 5349 :1986 ISO 8662 -11 | | | Sequential $a_{h,w}$ |
| Valore medio ponderato di vibrazione sull'impugnatura Weighted mean value of vibration on the grip Mittlerer Vibrationswert, am Griff Gemessen | Valeur moyenne pondérée de vibration mesurée sur la poignée Valor medio ponderado de vibracion medida en la empunadura | Valor medio ponderado de vibracao medida no punho Gewogen gemiddelde vibratiewaarde Middelvaardi af vibrationer pa handtaget | 4,65 m/s² |
| | | Bump $a_{h,w}$ | 4,75 m/s² |

Tipo di punto
Type of fastener
Befestigungselement
Type d'agrafe
Tipo de ponto
Tipo de ponto
Type nietjes
Tilspændingstype

700

1,40x1,60

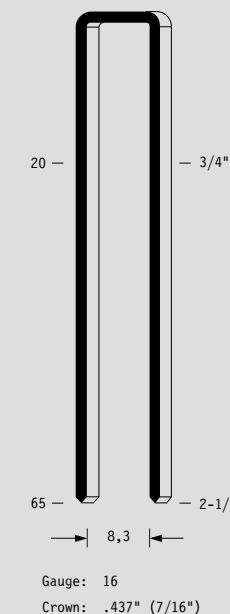

Parti di ricambio - Spare parts - Ersatzteile - Pièces de rechange - Piezas de repuesto
- Partes sobresselentes - Tabel te raadplegen - Reservedele

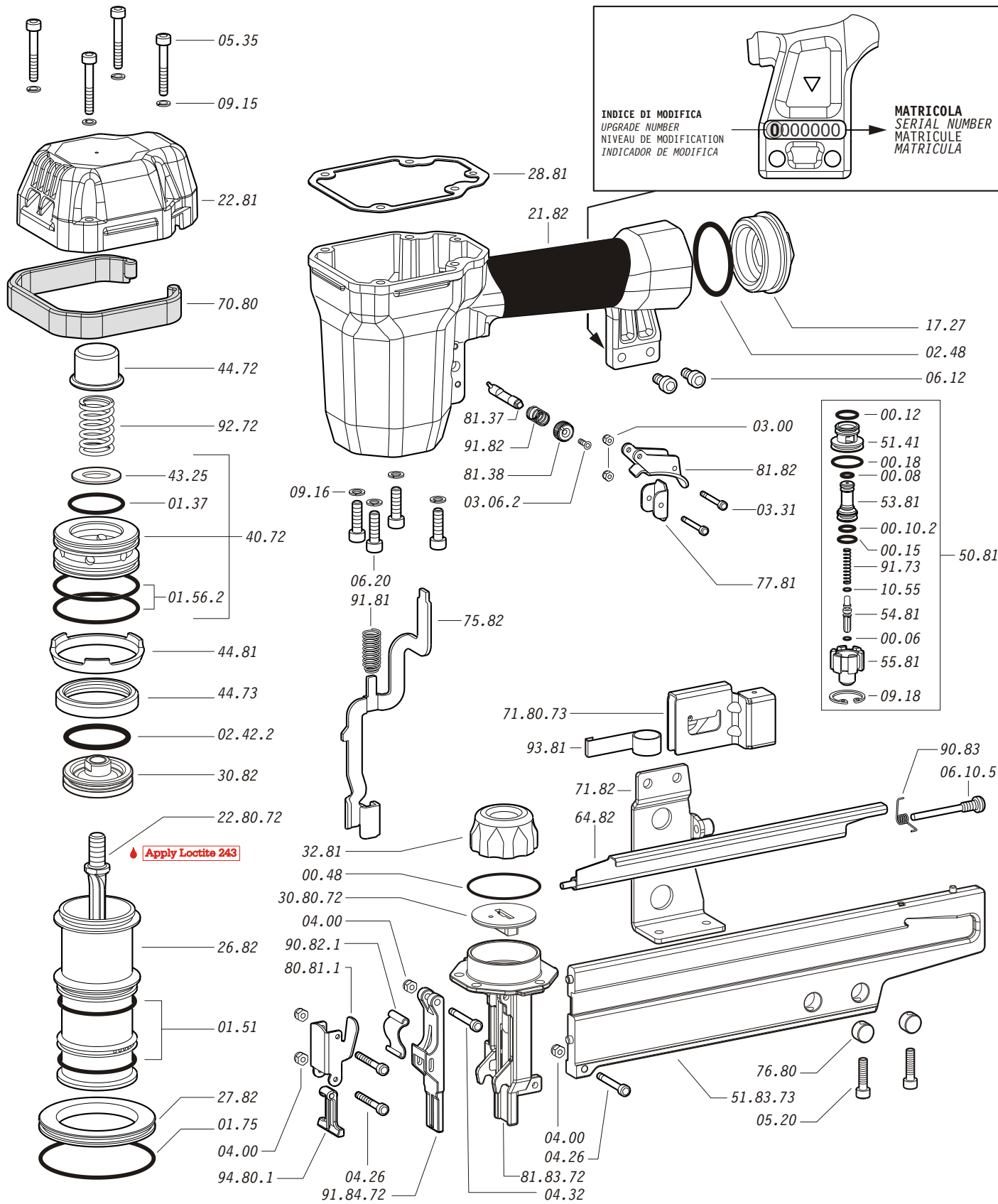

Dotazioni - Equipment - Ausrüstung - Équipements - Equipamiento -

Equipamento - Uitrusting - Udstyr

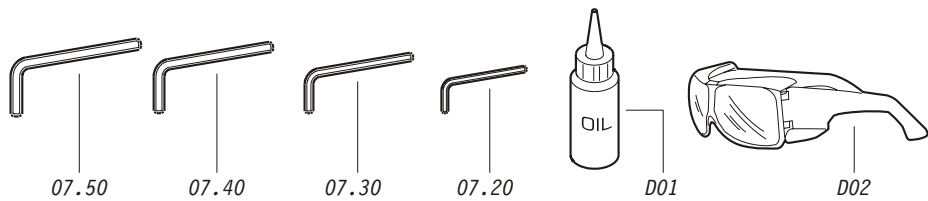

700.65 SB

cod. 1838310SB

Parti di ricambio - Spare parts - Ersatzteile - Pièces de rechange - Piezas de repuesto
- Partes sobresselentes - Tabel te raadplegen - Reservedele

| Cod. | Descrizione | Description |
|----------|----------------------|-----------------------|
| 00.06 | O-Ring | O-Ring |
| 00.08 | O-Ring | O-Ring |
| 00.10.2 | O-Ring | O-Ring |
| 00.12 | O-Ring | O-Ring |
| 00.15 | O-Ring | O-Ring |
| 00.18 | O-Ring | O-Ring |
| 00.48 | O-Ring | O-Ring |
| 01.37 | O-Ring | O-Ring |
| 01.51 | O-Ring | O-Ring |
| 01.56.2 | O-Ring | O-Ring |
| 01.75 | O-Ring | O-Ring |
| 02.42.2 | O-Ring | O-Ring |
| 02.48 | O-Ring | O-Ring |
| 03.00 | Dado | Nut |
| 03.06.2 | Vite | Screw |
| 03.31 | Vite | Screw |
| 04.00 | Dado | Nut |
| 04.26 | Vite | Screw |
| 04.32 | Vite | Screw |
| 05.20 | Vite | Screw |
| 05.35 | Vite | Screw |
| 06.10.5 | Vite | Screw |
| 06.12 | Vite | Screw |
| 06.20 | Vite | Screw |
| 07.20 | Chiave esagonale | Hex. bar wrench |
| 07.30 | Chiave esagonale | Hex. bar wrench |
| 07.40 | Chiave esagonale | Hex. bar wrench |
| 07.50 | Chiave esagonale | Hex. bar wrench |
| 09.15 | Rondella | Washer |
| 09.16 | Rondella | Washer |
| 09.18 | Anello elastico | Elastic ring |
| 10.55 | O-Ring | O-Ring |
| 17.27 | Tappo | Inlet cap |
| 21.82 | Corpo | Body |
| 22.81 | Testa | Head |
| 26.82 | Cilindro | Cylinder |
| 27.82 | Anello cilindro | Cylinder ring |
| 28.81 | Guarnizione testa | Head gasket |
| 30.82 | Pistone | Piston |
| 32.81 | Ammortizzatore | Bumper |
| 40.72 | Valvola completa | Valve ass'y |
| 43.25 | Rondella | Washer |
| 44.72 | Ammortizzatore | Bumper |
| 44.73 | Guarnizione cilindro | Cylinder gasket |
| 44.81 | Distanziale | Spacer |
| 50.81 | Pulsante completo | Trigger valve ass'y |
| 51.41 | Boccola pulsante | Trigger valve housing |
| 53.81 | Pistone servovalvola | Valve piston |
| 54.81 | Pulsante | Trigger valve |
| 55.81 | Raccordo pulsante | Bush |
| 64.82 | Carter | Hold down |
| 70.80 | Protezione | Guard |
| 71.82 | Reggicaricatore | Support |
| 75.82 | Sicura | Safety |
| 76.80 | Inserto | Nut screw |
| 77.81 | Guida sicura | Safety guide |
| 80.81.1 | Grilletto testina | Nose plate lock |
| 81.37 | Perno selettore | Selecting pin |
| 81.38 | Pomello | Knob |
| 81.82 | Grilletto comando | Trigger |
| 90.82.1 | Molla | Spring |
| 90.83 | Molla | Spring |
| 91.73 | Molla | Spring |
| 91.81 | Molla | Spring |
| 91.82 | Molla | Spring |
| 92.72 | Molla | Spring |
| 93.81 | Molla | Spring |
| 94.80.1 | Tirante | Connecting rod |
| 22.80.72 | Battente | Driver |
| 30.80.72 | Guida battente | Driver Guide |
| 51.83.73 | Caricatore | Magazine |
| 71.80.73 | Spingipunto | Pusher |
| 81.83.72 | Controtestina | Nose |
| 91.84.72 | Testina | Nose plate |
| D01 | Bocchetta olio | Oiler |
| D02 | Occhiali protettivi | Protective goggles |

- Kit O-Rings - O-ringen - Pakninger

Guarnizioni - O-Rings - Dichtungen - Joints - Kit O-Rings -

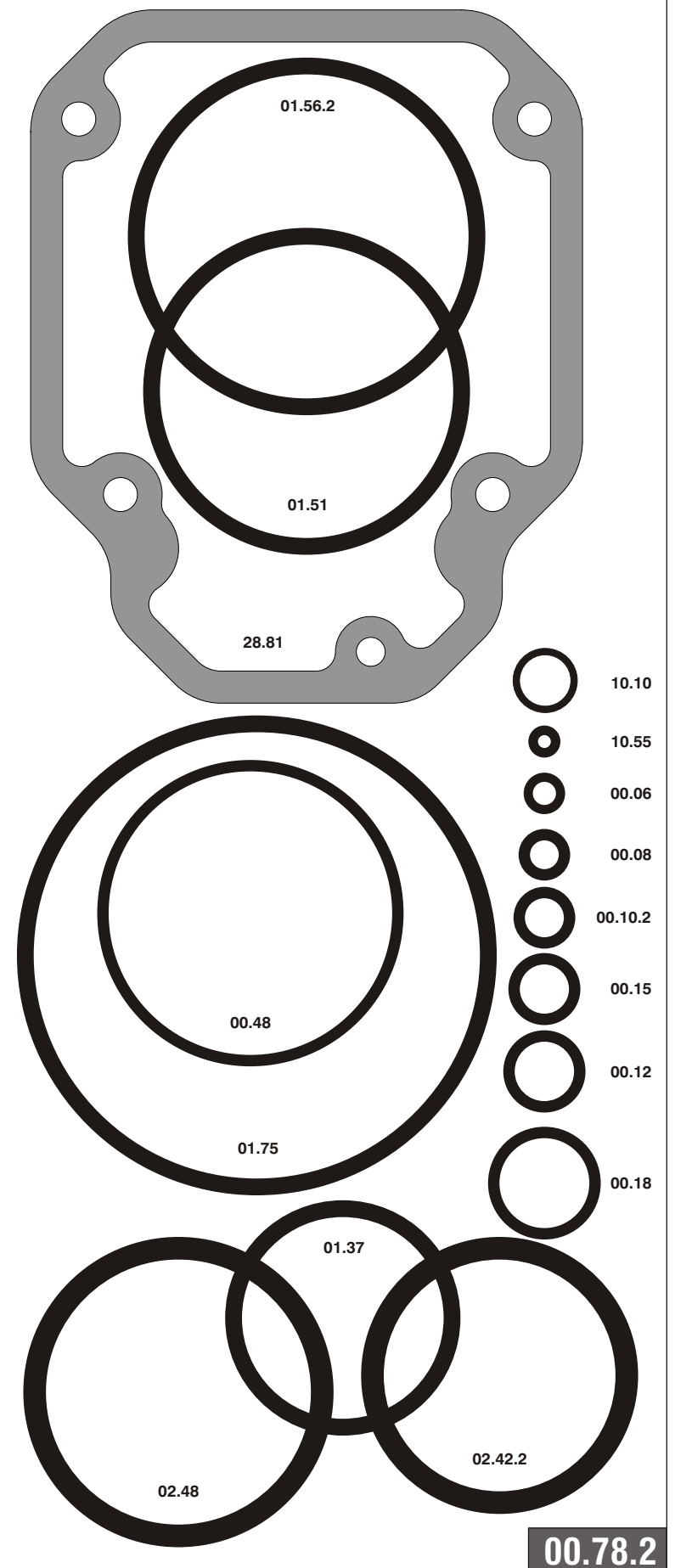

700.65 SB

cod. 1838310SB

Indice di modifica
Upgrade number

2

2174643